



Ponizio[®]

ALUMINIUM SYSTEMS

**SLIDING
WINDOWS AND DOORS**

LIFT AND SLIDE PATIO WINDOWS

PONZIO SL1600tt

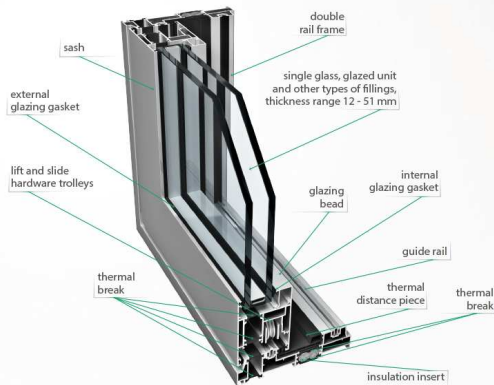

$U_w = 1,1 \text{ W/m}^2\text{K}$

*calculated for window: W 2400 x H 2400 mm
 $U_g = 0,5 \text{ W/m}^2\text{K}$, triple glazed unit

$U_w = 1,5 \text{ W/m}^2\text{K}$

$U_g = 1,0 \text{ W/m}^2\text{K}$, double glazed unit

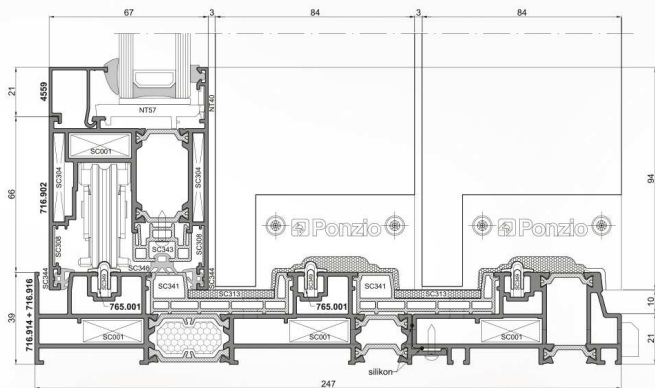

- aluminium system with thermal insulation designed for external sliding windows and doors
- constructions of large dimensions, up to 8 sashes available due to profiles design
- depth of profile: 67 mm for sliding sash profiles, 160 mm for double rail frame profile, 247 mm for triple rail frame profile, 334 mm for quadruple rail frame profile
- glazing thickness range 12 - 51 mm
- high resistance to weather conditions
- SL1600tt, SL1600tt+ and SL1600tt HI variants of system depending on applied insulation inserts
- low threshold solution available
- corner connection with movable ball joint
- trolley maximal lifting capacity 300 kg in standard, with additional trolleys maximal lifting capacity 400 kg
- automatic sliding drives available

LIFT AND SLIDE PATIO WINDOWS

PONZIO SL1600tt HI

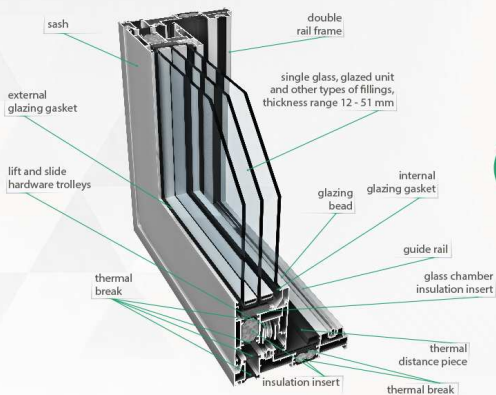

$$U_w = 1,0 \text{ W/m}^2\text{K}$$

*calculated for window
W 2400 x H 2400 mm | $U_g = 0,5 \text{ W/m}^2\text{K}$
triple glazed unit

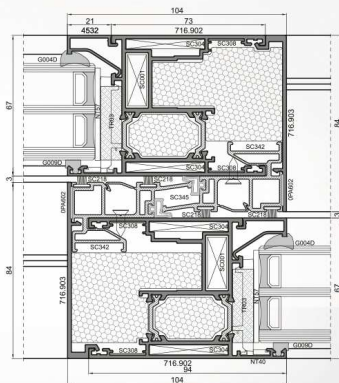
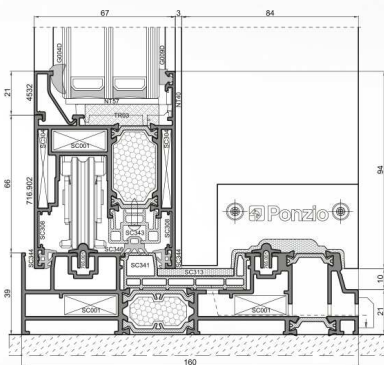

- variant of SL1600tt designed for external sliding windows and doors with high thermal insulation requirements
- U_f starts from 2,1 W/m²K in PLUS variant and in HI variant U_f starts from 1,8 W/m²K